

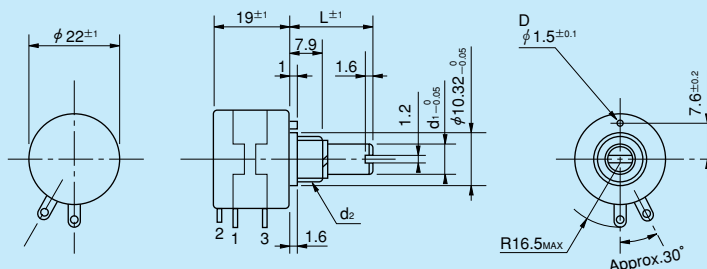

● Standard Dimensions

■ Bushingmount type



Note: Dimensions of shaft and bushing are equal to those of model 22HP series with wirewound resistive element and please refer to those dimensions and notes.

■ Servomount type (bronze bearing incorporated)

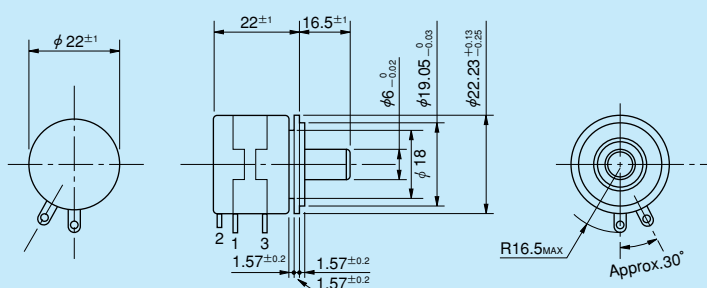

● Standard Model Nos.

**Bushingmount type:**

5-turn models:	22HHP-5	22HHP-5M
	22HHP-5E	22HHP-5N
10-turn models:	22HHP-10	22HHP-10M
	22HHP-10E	22HHP-10N

**Servomount type:**

5-turn models:	22HHP-5
10-turn models:	22HHP-10

● General Specifications

**Standard Resistance Values:**

1k,2k,5k,10k,20k,50k (Ω) (5-turn)  
2k,5k,10k,20k,50k,100k (Ω)(10-turn)

**Total Resistance Tolerance:**

Standard Class ±10% (K)  
Precision Class ±5% (J)

**Independent Linearity Tolerance:**

	5-turn	10-turn
Standard Class	±0.35%	±0.25%
Precision Class	±0.2%	±0.1%

**Resolution:**

Essentially infinite

**Output Smoothness:**

Within 0.05% against input voltage (5-turn)  
Within 0.015% against input voltage (10-turn)

**Contact Resistance Variation:**

Within 5% C.R.V. (5-turn)  
Within 3% C.R.V. (10-turn)

**Power Rating:**

1.0W (5-turn)  
2.0W (10-turn)

**Electrical Travel:**

360° × n ± 5° (n: No. of turns)

**Mechanical Travel:**

360° × n <sup>+10°</sup><sub>0</sub> (n: No. of turns)

**Insulation Resistance:**

Over 100MΩ at 1,000V.D.C.

**Dielectric Strength:**

1 minute at 1,000V.A.C.

**Starting Torque:**

Within 5mN·m (50gf·cm)

**Stopper Strength:**

Approx. 0.9N·m (9kgf·cm)

**Max. Working Voltage:**

500V

**Resistance Temperature Coefficient:**

±100p.p.m./°C

**Max. Torque exerted on fastening the mounting nut to the bushing:**

Within 1.0N·m (10kgf·cm)  
(In case of panel thickness with over 2.5mm., the rotating torque may become heavier.)

**Mass:**

Approx. 25g (Bushingmount)  
Approx. 30g (Servomount)  
(Both 5-turn and 10-turn)

● Special Specifications Available

Rear shaft (with 6mm dia. and 15mm length), 3-turn type, Multi-ganged (Available up to 10 gangs), High torque, Special shaft dia. (φ 3mm, φ 3.175mm, φ 4mm, φ 5mm, φ 6.35mm), Special machining on the shaft, With Plastic shaft, Metal bushing (22HHPM with anti-rotation pin), Simple sealed housing, Extra taps (Available up to 1 tap only for 10-turn), Slipping-clutch incorporated type (20mN·m~60mN·m).